

NO.	DATE	DESCRIPTION	BY



7010 Easy Wind Dr. Ste 200  
Austin, TX 78752  
512.899.3100

www.designopa.com



150 COPPER ST.  
HENDERSON, NEVADA

**NOTES:**

- ① WC, 3" S, 2" V.
- ② L, SH, 2" S, 1 1/2" V.
- ③ KS/DW, 2" S, 1 1/2" V. OR INSTALL 1 1/2" MINI STUDDOR VENT.
- ④ 2" S, 1 1/2" V. TO DUEL CLOTHES WASHER BOX.
- ⑤ 1 1/2" VTR, MAINTAIN 10 FT. CLEARANCE TO FRESH AIR INTAKES.
- ⑥ 2" VTR, MAINTAIN 10 FT. CLEARANCE TO FRESH AIR INTAKES.
- ⑦ 2" S, DOWN TO BELOW.
- ⑧ 1 1/2" DRAIN PIPING FROM CLOTHES WASHER DRAIN PAN ROUTE TO EXTERIOR.
- ⑨ 3" S, DOWN TO BELOW.
- ⑩ GAS TANKLESS WATER HEATER, ROUTE CONCENTRIC VENT UP THRU ROOF, MAINTAIN 10 FT. CLEARANCE TO FRESH AIR INTAKES.

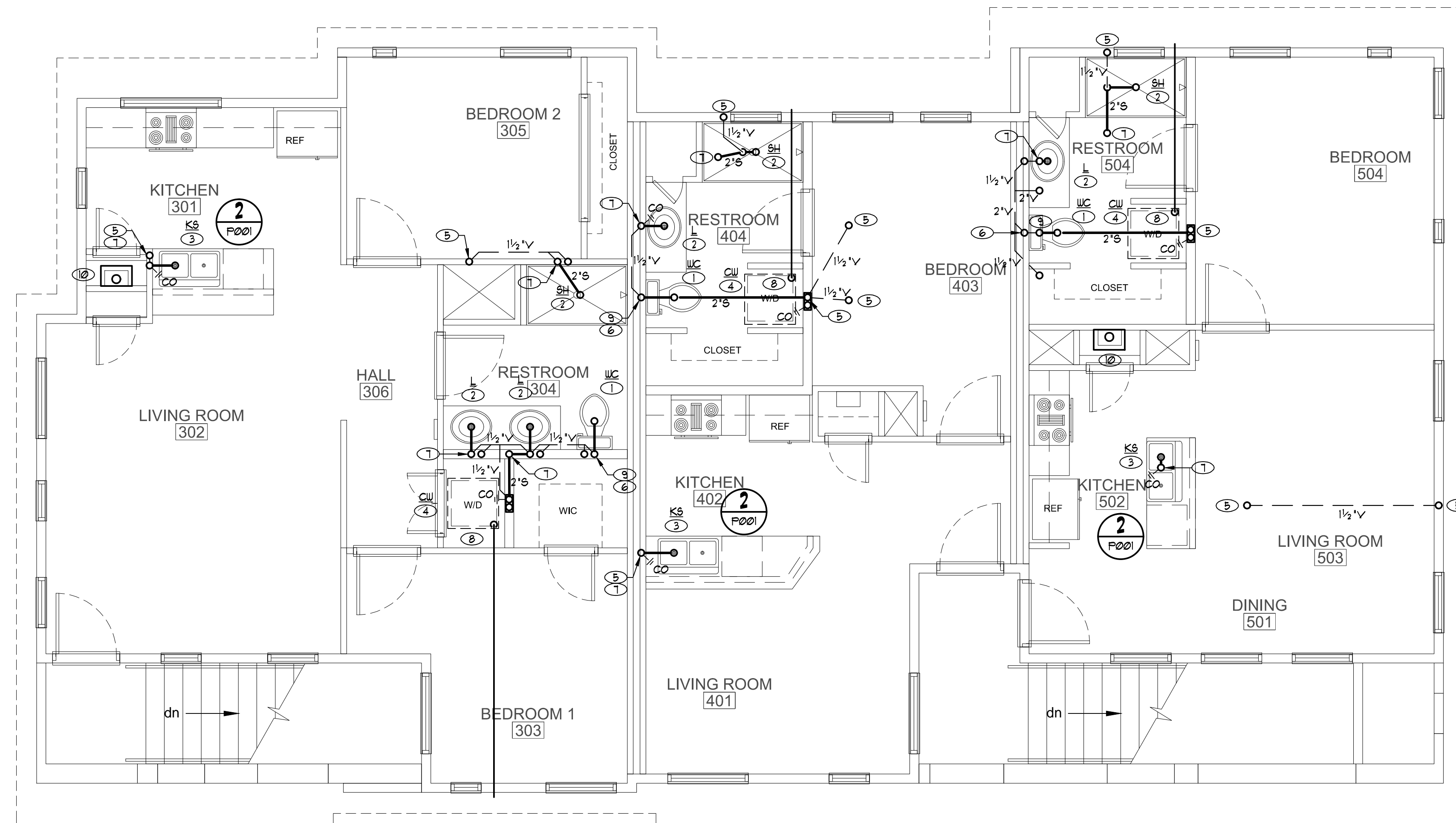

**SECOND FLOOR - PLUMBING PLAN (WASTE & VENT)**

SCALE: 1/4" = 1'-0"



©2018 OPA Design Studio. All Rights Reserved. These designs/drawings are the sole property of the Architect, OPA Design Studio. They may not be reproduced in any form, by any method, for any purpose without previous written permission from the Architect.

JOB NO.:	201724-C
PHASE:	CD
DRAWN:	SO, LE
CHECKED:	SO
DATE:	10/22/2018

**P102**